

D1 Energy meter

DDSU6606 Single phase electronic energy meter (guide rail)



Selecti on guide

Product name	voltage	Accuracy class	1) Specifications	Functional option
DDSU6606	M	1	10M4	
	M:220V	1:1LEVEL 2:2LEVEL	10M4:2.5 (10) A .. 80M420 (80) A	CDI485: Liquid crystal, infrared, 485 Default: Direct And meter display

Name	Model number	Reference voltage	Accuracy class	Basic current (rated maximum current)(A)
Single-phase electronic type Energy meter (guide rail)	DDSU6606	220	1	2.5(10)、5(20)、10(40)、15(60)、20(80)

Note: 1) The "M" in the specification code indicates the current multiple

Order example:

If the customer needs DDSU6606 single-phase electronic energy meter (guide, LCD, infrared, 485), the voltage is 220V, the accuracy level is 1, and the current specification is 10(40)A, the corresponding order code is DDSU6606M140M4CD1485

Product characteristics

- Small size, light weight, modular structure, using the standard 35mm rail installation, can be convenient to use with the micro circuit breaker Data display using liquid crystal display, intuitive reading
- It has wide range, stronger overload capacity, high measurement accuracy and good reliability
- With infrared and RS485 communication functions

Technical parameter

Certification certificate	MC 浙制00000321号
International standard	EC 62053-21
National standard	GB/T 17215.321
Current specification	2.5(10)、5(20)、10(40)、15(60)、20(80)
Reference voltage	220
Accuracy class	1
Power dissipation	Voltage line 2W, 10VA, current line 1VA
Bidirectional metering function	It can measure positive and reverse active energy, and accumulate electricity in one direction
Project requirement	If you need other functions, the user can put forward specific requirements when ordering

D1 Energy Meter

DDSU6606 Single phase electronic energy meter (guide rail)

Dimensions and mounting dimensions (mm)

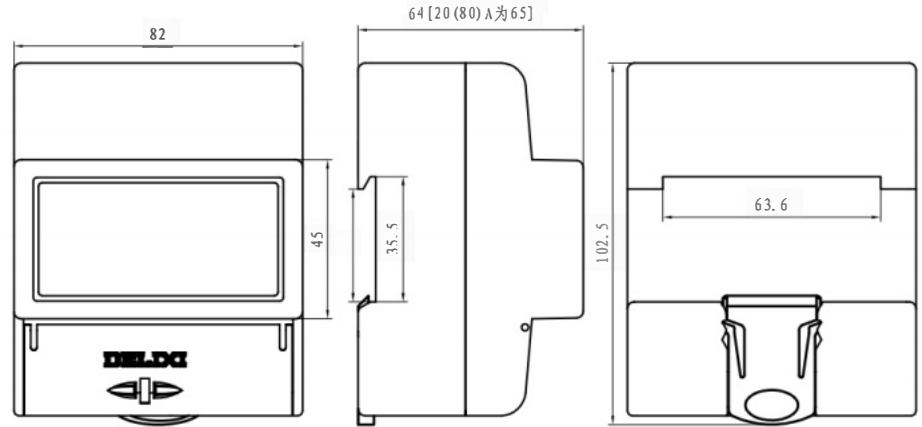

Operating environment and working conditions

- Ambient temperature: the specified working ambient temperature is: -10 ~ +45
- Ambient humidity: annual average relative humidity $\leq 75\%$

Wiring diagram

Liquid crystal, infrared, 485:

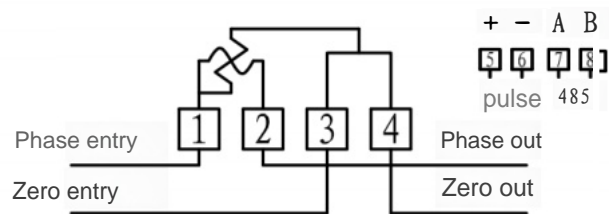

Meter:

